

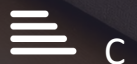

## Whitehouse Apartments

9 Belvedere Road, South Bank, SE1 8YP

Asking Price £550,000



## Floor Plan

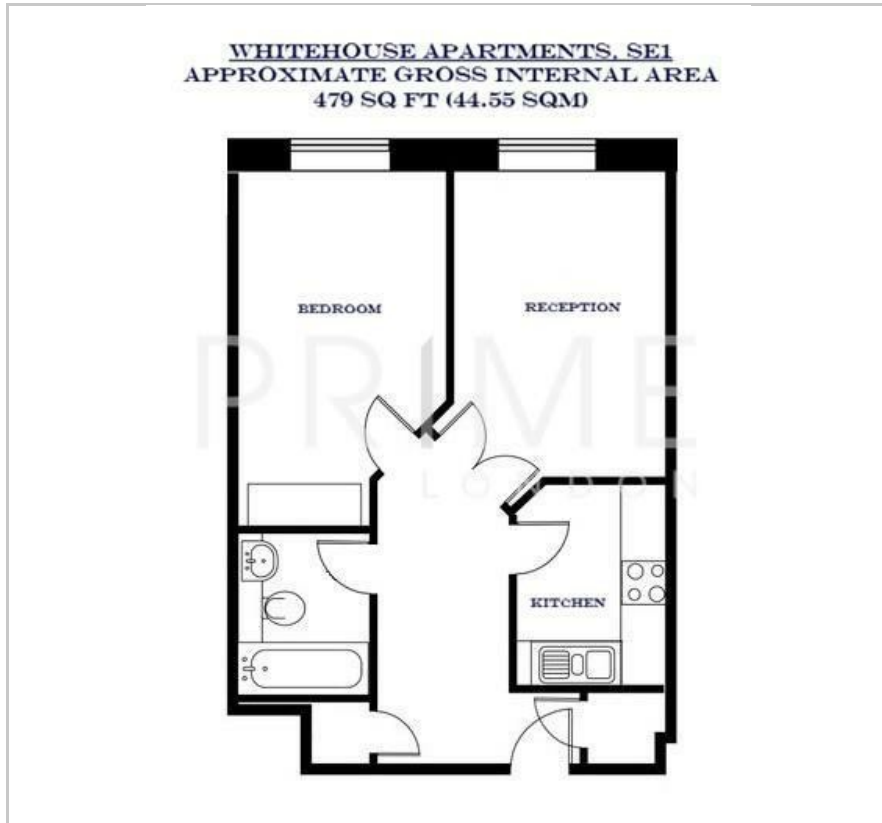

## Area Map



## Energy Efficiency Graph

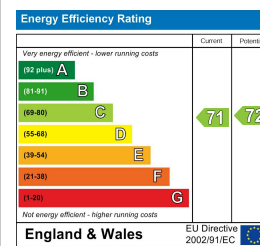

## Viewing

By appointment. Contact us on 0207 928 6663 if you wish to arrange a viewing appointment for this property, or require further information.

- Stunning apartment
- Secure underground parking
- 24 hour concierge
- Fully equipped gymnasium
- 479 sq ft (44.55 sqm)
- Chain free
- Residents' roof terrace
- Heated swimming pool, steam room and sauna

Extending to 479 sq ft (44.55 sqm), this well presented apartment within the sought after Whitehouse Apartments, offered inclusive of a secure parking space, offers an ideal executive home, and is available chain free through Prime London.

The property comprises a spacious reception room, a fully fitted kitchen, a well proportioned bedroom, and a contemporary family bathroom.

Residents benefit from exclusive access to a spa and fitness suite, including a fully equipped gym, heated swimming pool, steam room, and sauna, as well as a 24 hour concierge service and a communal roof terrace.

Ideally located moments from the South Bank, the property is surrounded by a wealth of renowned restaurants, cafés, shops, and cultural attractions. Waterloo Station is within close proximity, providing excellent transport links via the Bakerloo, Jubilee, Northern, and Waterloo & City lines.



These particulars, whilst believed to be accurate are set out as a general outline only for guidance and do not constitute any part of an offer or contract. Intending purchasers should not rely on them as statements of representation of fact, but must satisfy themselves by inspection or otherwise as to their accuracy. No person in this firm's employment has the authority to make or give any representation or warranty in respect of the property.